

Contact Sensor

Wire probe GM Series

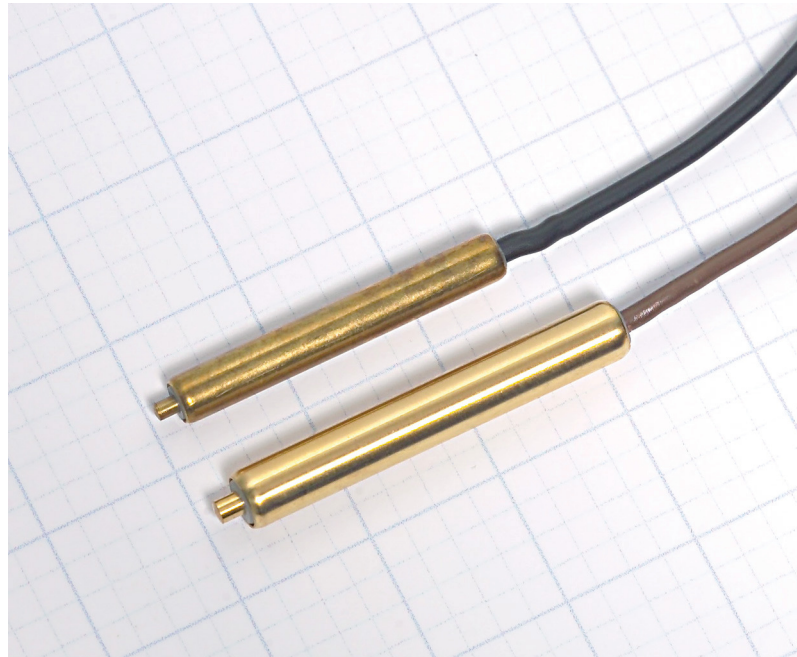

Application

In touch with a grounded part (die, stamping strip) the wire probe detects a negative (low) switching signal.

The sensor can be used for checking part position or riveted bolt (see applications).

With two wire probes it's also possible to make a dimensional check.

Technical features

- Exactly switching
- Metal housing
- Easy installation
- No electronic necessary
- One wire cable

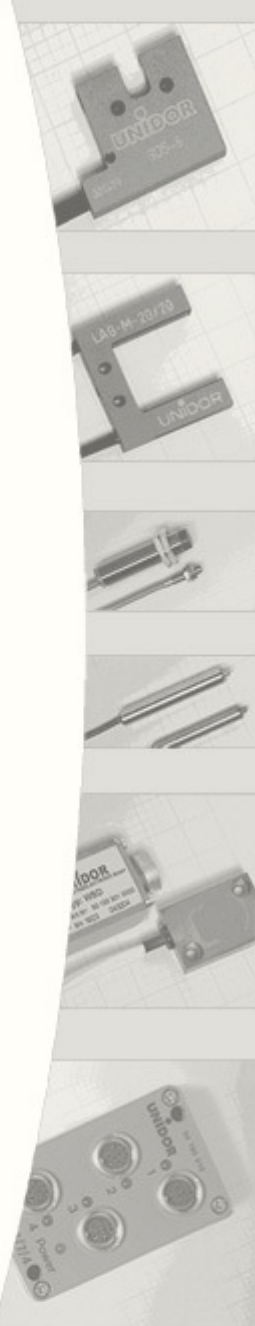

UNIDOR GmbH
 Freiburger Str. 3
 D-75179 Pforzheim

Tel +49(0)7231/3152-0
 Fax +49(0)7231/3152-99
 info@unidor.de | www.unidor.de

Contact Sensor

Wire probe GM Series

Technical Data

Spring deflection:	1,5mm
Sizes:	4mm – 5mm – 8mm – M10x1
Cable length:	2,5m w/o plug
Output:	n-switching
Operating temperature	0 °C... +40 °C
Housing:	Brass

Dimensions

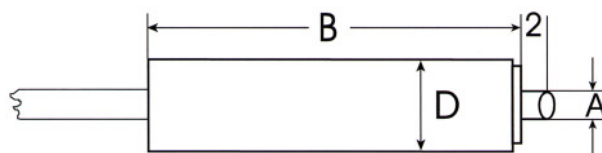

Type	A	B	D
GM 04	1,5mm	28mm	4mm
GM 05	2,0mm	33mm	5mm
GM 08	3,0mm	33mm	8mm
GM M10x1	2,0mm	33mm	M10x1

Checking for part position

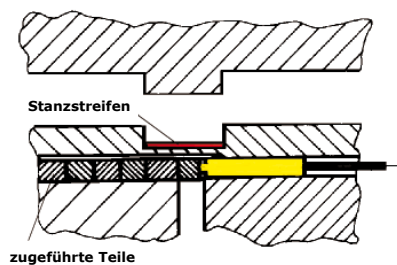

Checking for riveted bolt

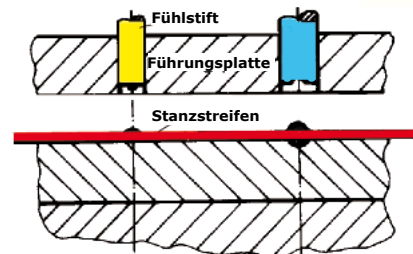

Order Data

Article-No.	Short term	Description
500701010000	Wire probe GM 04	Wire probe GM 04 w/o plug and 2,5m cable
500701020000	Wire probe GM 05	Wire probe GM 05 w/o plug and 2,5m cable
500701040000	Wire probe GM 08	Wire probe GM 08 w/o plug and 2,5m cable
500701030000	Wire probe GM M10x1	Wire probe GM M10x1 w/o plug and 2,5m cable